

INDUSTRIAL PRESSURE TRANSMITTER

Swiss based Trafag is a leading international supplier of high quality sensors and monitoring instruments for measurement of pressure and temperature. The industrial pressure transmitter NAT 8252 features an exceptionally long-term stable thin-film-on-steel sensor cell with triple (optionally 5-fold) overpressure safety. Optionally, the NAT 8252 is available as a pressure switch with 1 or 2 switching outputs. The robust design and the wide temperature range from -40°C to +125°C qualify the NAT 8252 as the ideal solution for a wide range of demanding applications.



Applications

- Machine tools
- Hydraulics
- HVAC
- Refrigeration
- Process technology
- Water treatment

Features

- Smallest design
- Completely welded steel sensor system without additional seals
- Excellent long-term stability
- Optional: fivefold overpressure resistance
- Optional: Switching output 1 or 2 PNP transistors

Technical Data			
Measuring principle	Thin film on steel	Accuracy @ 25°C typ.	± 0.5 % FS typ.
Measuring range	0 ... 2.5 to 0 ... 600 bar 0 ... 30 to 0 ... 7500 psi	Media temperature	-40°C ... +125°C
Output signal	4 ... 20 mA, 0.5 ... 4.5 VDC, 0 ... 5 VDC, 1 ... 5 VDC, 1 ... 6 VDC, 0 ... 10 VDC, 0.1 ... 10.1 VDC, 0.5 ... 4.5 VDC ratiometric, Switching output: 1 or 2 PNP transistors	Ambient temperature	-40°C ... +125°C (Cable PVC 22: -5°C ... +60°C) (Cable PUR 24: -40°C ... +70°C)

10/2017

Data sheet H723030

Subject to change

Ordering information/type code

				8252 . XX	XX	XX	XX	XX	XX	
Measuring range ¹⁾	Pressure measurement range [bar]	Over pressure [bar]	Burst pressure [bar]							
	0 ... 2.5	7.5	50	75						
	0 ... 4	12	60	76						
	0 ... 6	18	100	77						
	0 ... 10	30	200	78						
	0 ... 16	48	200	79						
	0 ... 25	75	300	80						
	0 ... 40	120	300	81						
	0 ... 60	180	400	82						
	0 ... 100	300	500	83						
	0 ... 160	480	750	85						
	0 ... 250	750	1000	74						
	0 ... 400	1000	2000	84						
	0 ... 600	1500	2500	86						
	Option 5P:	Fivefold overpressure								
	0 ... 2.5	12.5	60	55						
	0 ... 4	20	100	56						
	0 ... 6	30	200	57						
	0 ... 10	50	200	58						
	0 ... 16	80	300	59						
	0 ... 25	125	300	60						
	0 ... 40	200	400	61						
	0 ... 60	300	500	62						
	0 ... 100	500	750	63						
0 ... 160	800	1000	65							
Pressure measurement range [psi]	Over pressure [psi]	Burst pressure [psi]								
0 ... 30	90	700	G5							
0 ... 50	150	850	G6							
0 ... 100	300	1450	G7							
0 ... 150	450	2500	G8							
0 ... 200	600	2500	GA							
0 ... 250	750	2500	G9							
0 ... 300	900	4000	HA							
0 ... 400	1200	4000	H0							
0 ... 500	1500	4000	H1							
0 ... 1000	3000	5000	H2							
0 ... 1500	4500	7000	H3							
0 ... 2000	6000	10000	H5							
0 ... 3000	9000	14500	G4							
0 ... 5000	12500	21750	H4							
0 ... 7500	18750	29000	H6							
Sensor	Relative pressure				25					
Pressure connection	G1/4" male, seal: DIN 3869 (accessories 61/63/83)				17					
	G1/4" male (Manometer) EN 871 ⁹⁾				53					
	1/4" NPT male				30					
	1/8" NPT male ^{5) 9)}				43					
	7/16"-20UNF female SAE J512 with valve opener ⁴⁾				24					
	7/16"-20UNF female SAE J512 without valve opener ⁴⁾				44					
	7/16"-20UNF male, DIN3866 ⁴⁾				18					
	7/16"-20UNF SAE4 male, seal: accessory 61 ⁸⁾				42					
	R1/4" male, DIN3858 ⁵⁾				19					
	R1/8" male, DIN3858 ⁵⁾				16					
	M10x1 male, DIN EN ISO 6149-2				32					
	M12x1.5 male, DIN EN ISO 9974-2 ⁹⁾				49					
	Electrical connection	Male electrical plug, industrial standard, contact distance 9.4 mm, Mat. PA				01				
Male electrical plug M12x1, 4-pole, Mat. PA				32						
Male electrical plug M12x1, 5-pole, Mat. PA				35						
Cable IP67, Mat. PVC ⁷⁾				22						
Cable IP67, Mat. PUR ⁷⁾				24						
Cable IP67, Mat. EPD Raychem FDR25 ⁷⁾				08						

Output signal	Signal output	Load resistance	I (supply)	U (supply)	
	4 ... 20mA	See graphic		24 (9 ... 32) VDC	19
	0.5 ... 4.5 VDC	≥ 5.0 kΩ to Us-	≤ 20 mA	24 (9 ... 32) VDC	20
	0 ... 5 VDC	≥ 5.0 kΩ to Us-	≤ 20 mA	24 (9 ... 32) VDC	14
	1 ... 5 VDC	≥ 5.0 kΩ to Us-	≤ 20 mA	24 (9 ... 32) VDC	25
	1 ... 6 VDC	≥ 5.0 kΩ to Us-	≤ 20 mA	24 (9 ... 32) VDC	16
	0 ... 10 VDC	≥ 5.0 kΩ to Us-	≤ 15 mA	24 (15 ... 32) VDC	17
	0.1 ... 10.1 VDC	≥ 5.0 kΩ to Us-	≤ 15 mA	24 (15 ... 32) VDC	13
	0.5 ... 4.5 VDC ratiometric	≥ 5.0 kΩ to Us-	≤ 10 mA	5 (4.75 ... 5.25) VDC	23
	2 PNP transistors ³⁾		≤ 10 mA	24 (9 ... 32) VDC	PS
	1 PNP transistor ³⁾		≤ 10 mA	24 (9 ... 32) VDC	T1
Accessories	Female electrical plug M12x1, 5-pole ²⁾				33
	Female electrical connector industrial standard (for electrical connection 01)				34
	Pressure peak damping element ø 1.0 mm ⁶⁾				40
	Pressure peak damping element ø 0.4 mm ⁶⁾				44
	Seal FPM, -18°C ... +125°C				61
	Seal EPDM, -40°C ... +125°C				63
	Seal NBR, -25°C ... +100°C				83
	Special electrical connection: Pin 2 +, Pin 3 ground, Pin 4 - (only for output signal 19 and male electrical plug 01, industrial standard)				90
	Special electrical connection: Pin 1 out, Pin 2 +, Pin 3 ground, Pin 4 - (only for output signals 14, 16, 17, 23 and male electrical plug 01, industrial standard)				91
	Special electrical connection: Pin 1 +, Pin 2 Ground, Pin 3 -, Pin 4 Out (only for output signals 14, 16, 17, 23 and male electrical plug 32, M12x1, 4-pole)				96
	Special electrical connection: Pin 1 +, Pin 2 -, Pin 4 ground (only for output signal 19 and male electrical plug 01, industrial standard)				92
	Special electrical connection: Pin 1 +, Pin 2 -, Pin 4 ground (only for output signal 19 and male electrical plug 32, M12x1, 4-pole)				E1
	Special electrical connection: Pin 1 +, Pin 2 -, Pin 3 out, Pin 4 ground (only for output signals 14, 16, 17, 23 and male electrical plug 32, M12x1, 4-pole)				E2
	Cable length 0.5 m				EM
	Cable length 1.0 m				1M
	Cable length 2.0 m				2M
	Parameterisation according to customer specification (see table parameter), for output signal PS, T1				ZC

¹⁾ Customized pressure ranges upon request

²⁾ For electrical connections 32 and 35

³⁾ Only with electrical connections 32, 22, 24, 08

⁴⁾ Max. allowable pressure range 60 bar at 120 bar overpressure

⁵⁾ Max. allowable pressure range 160 bar at 500 bar overpressure

⁶⁾ Only for pressure connections 17, 30, 32

⁷⁾ Cable length see accessories

⁸⁾ According to norm J1926, max. 35 MPa

⁹⁾ Upon request

Standard products (extra short lead time)

Product No.	Type Code	Pressure range [bar]	Over pressure max. [bar]	Supply [VDC]	Accuracy @ 25°C typ. [%]
NAT2.5A	8252 75 2517 01 0000 0000 19 34 44 61	0 ... 2.5	7.5	9 ... 32	±0.5
NAT4.0A	8252 76 2517 01 0000 0000 19 34 44 61	0 ... 4	12	9 ... 32	±0.5
NAT6.0A	8252 77 2517 01 0000 0000 19 34 44 61	0 ... 6	18	9...32	±0.5
NAT10.0A	8252 78 2517 01 0000 0000 19 34 44 61	0 ... 10	30	9...32	±0.5
NAT16.0A	8252 79 2517 01 0000 0000 19 34 44 61	0 ... 16	48	9 ... 32	±0.5
NAT25.0A	8252 80 2517 01 0000 0000 19 34 44 61	0 ... 25	75	9 ... 32	±0.5
NAT40.0A	8252 81 2517 01 0000 0000 19 34 44 61	0 ... 40	120	9 ... 32	±0.5
NAT100.0A	8252 83 2517 01 0000 0000 19 34 44 61	0 ... 100	300	9 ... 32	±0.5
NAT250.0A	8252 74 2517 01 0000 0000 19 34 44 61	0 ... 250	750	9 ... 32	±0.5
NAT400.0A	8252 84 2517 01 0000 0000 19 34 44 61	0 ... 400	1000	9 ... 32	±0.5
NAT600.0A	8252 86 2517 01 0000 0000 19 34 44 61	0 ... 600	1500	9 ... 32	±0.5
NAT2.5V	8252 75 2517 01 0000 0000 17 34 44 61	0 ... 2.5	7.5	15 ... 32	±0.5
NAT4.0V	8252 76 2517 01 0000 0000 17 34 44 61	0 ... 4	12	15 ... 32	±0.5
NAT6.0V	8252 77 2517 01 0000 0000 17 34 44 61	0 ... 6	18	15 ... 32	±0.5
NAT10.0V	8252 78 2517 01 0000 0000 17 34 44 61	0 ... 10	30	15 ... 32	±0.5
NAT16.0V	8252 79 2517 01 0000 0000 17 34 44 61	0 ... 16	48	15 ... 32	±0.5
NAT25.0V	8252 80 2517 01 0000 0000 17 34 44 61	0 ... 25	75	15 ... 32	±0.5
NAT40.0V	8252 81 2517 01 0000 0000 17 34 44 61	0 ... 40	120	15 ... 32	±0.5
NAT100.0V	8252 83 2517 01 0000 0000 17 34 44 61	0 ... 100	300	15 ... 32	±0.5
NAT250.0V	8252 74 2517 01 0000 0000 17 34 44 61	0 ... 250	750	15 ... 32	±0.5
NAT400.0V	8252 84 2517 01 0000 0000 17 34 44 61	0 ... 400	1000	15 ... 32	±0.5
NAT600.0V	8252 86 2517 01 0000 0000 17 34 44 61	0 ... 600	1500	15 ... 32	±0.5

Parameter				
Name	Standard setting (accessory ZS)	Value range	Short name	Customer adjustment (accessory ZC)
Switch point SP1 (hysteresis mode) Upper switch point FH1 (window mode)	75 % Measuring range	> RP1, FL1 Hysteresis \geq 1 % FS	SP1	
Reset point RP1 (hysteresis mode) Lower switch point FL1 (window mode)	25 % Measuring range	< SP1, FH1 Hysteresis \geq 1 % FS	RP1	
Switch point SP2 (hysteresis mode) Upper switch point FH2 (window mode)	75 % Measuring range	> RP2, FL2 Hysteresis \geq 1 % FS	SP2	
Reset point RP2 (hysteresis mode) Lower switch point FL2 (window mode)	25 % Measuring range	< SP2, FH2 Hysteresis \geq 1 % FS	RP2	
Switch point delay time SP1 / RP1 (hysteresis mode) Switch point delay time FH1 / FL1 (window mode)	0	0; 2 ^x [ms], x = 3, 4 ... 16	dS1	
Switch point delay time SP2 / RP2 (hysteresis mode) Switch point delay time FH2 / FL2 (window mode)	0	0; 2 ^x [ms], x = 3, 4 ... 16	dS2	
Functions switching output 1	Hysteresis, closer (Hno)	Hysteresis NO (Hno), Hysteresis NC (Hnc) Window NO (Fno), Window NC (Fnc)	ou1	
Functions switching output 2	Hysteresis, closer (Hno)	Hysteresis NO (Hno), Hysteresis NC (Hnc) Window NO (Fno), Window NC (Fnc) Device ready	ou2	

Specifications		
Electrical Data	Output / supply voltage	4 ... 20 mA: 24 (9...32) VDC 0.5 ... 4.5 VDC: 24 (9...32) VDC 0 ... 5 VDC: 24 (9...32) VDC 1 ... 5 VDC: 24 (9...32) VDC 1 ... 6 VDC: 24 (9...32) VDC 0 ... 10 VDC: 24 (15...32) VDC 0.1 ... 10.1 VDC: 24 (15...32) VDC 0.5 ... 4.5 VDC ratiom., 10 ... 90% U_{supply} : 5 ± 0.25 VDC 1 or 2 PNP transistors: 24 (9...32) VDC
	Rise time	Typ. 1 ms / 10 ... 90 % nominal pressure
	Switch-on-delay pressure transmitters	100 ms
	Switch-on-delay pressure switches	50 ms + switching delay time
	Inverse-polarity protection, short-circuit strenght @ 25°C during 5 min.	4...20 mA: to $U_s = 32$ VDC 0.5...4.5 VDC, 0...5 VDC, 1...5 VDC, 1...6 VDC, 0...10 VDC, 0.1...10.1 VDC: to $U_s = 28$ VDC 0.5...4.5 VDC ratiometric: to $U_s = 14$ VDC 1 or 2 PNP transistors: to $U_s = 32$ VDC
Environmental conditions	Media temperature	-40°C ... +125°C
	Ambient temperature	-40°C ... +125°C (Cable PVC 22: -5°C ... +60°C) (Cable PUR 24: -40°C ... +70°C)
	Protection ¹⁾	IP65, IP67
	Humidity	Max. 95 % relative
	Vibration	15 g RMS (20...2000 Hz) (EN60068-2-64) 25 g sin (80...2000 Hz), 1 oct./min, (1x @ 25°C) (EN60068-2-6)
	Shock	50 g / 11 ms 100 g / 6 ms Male electrical plug M12x1 (EN60068-2-27) ²⁾
EMC Protection	Emission	EN/IEC 61000-6-3
	Immunity	EN/IEC 61000-6-2
Mechanical Data	Sensor (wetted parts)	1.4542 (AISI630)
	Pressure connection (wetted parts)	1.4542 (AISI630)
	Housing	1.4301 (AISI304)
	Sealing	FPM/EPDM/NBR
	Male electrical plug	See ordering information
	Weight	appr. 50 g
	Mounting torque	25 Nm

¹⁾ See electrical connection

²⁾ For electrical connections 32 and 35

Analogue output

Accuracy	TEB @ -25 ... +85°C	[% FS typ.]	± 1.75
	Accuracy @ +25°C	[% FS typ.]	± 0.5
	NLH @ +25°C (BSL)	[% FS typ.]	± 0.2
	TC zero point and span	[% FS/K typ.]	± 0.03
	Long term stability 1 year	[% FS typ.]	± 0.1
Rise time	Typ. 1 ms / 10 ... 90 % nominal pressure		

Switching output

Accuracy	TEB @ -25 ... +85°C	[% FS typ.]	± 1.75
	Accuracy @ +25°C	[% FS typ.]	± 0.5
	Long term stability 1 year	[% FS typ.]	± 0.1
Adjustment range of switchpoints	1 ... 99 % FS		
Distance switch point	≥ 1.0 % FS		
Switch point > reset point	Switchpoint > reset point		
Switching resistance	≤ 3 Ω		
Output function	Hysteresis, Window; normally closed (NO), normally open (NC)		
Switching current	-40°C ... +85°C	(Ambient and media temperature)	≤ 400 mA, total of both switching outputs
	+85°C ... +125°C	(Ambient and media temperature)	≤ 200 mA, total of both switching outputs
Current limiting	integrated		
Delay time	0; 2 ^x [ms], x = 3, 4 ... 16		
Switching frequency	max. 60 Hz (at switching delay time = 0)		

Measuring accuracy

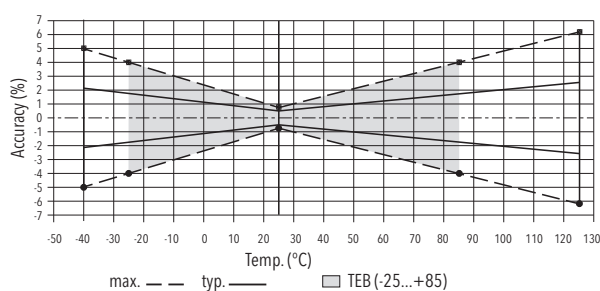

Dimensions

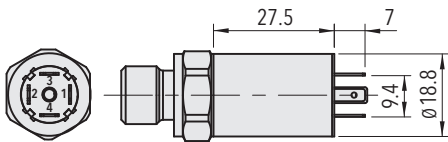

8252.XX.XXXX.01.XX.XX

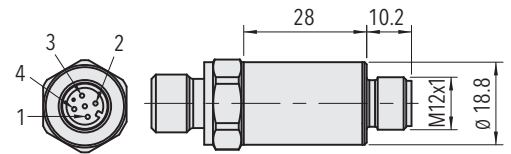

8252.XX.XXXX.32.XX.XX

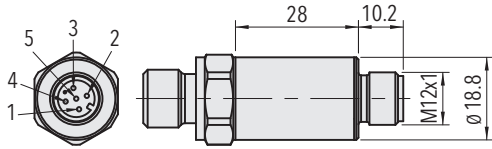

8252.XX.XXXX.35.XX.XX

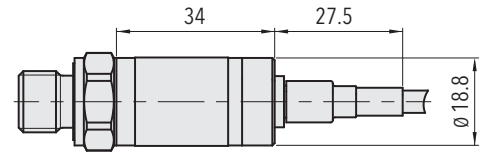

8252.XX.XXXX.22/24/08.XX.XX

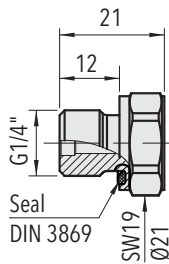

8252.XX.XX17.XX.XX.XX

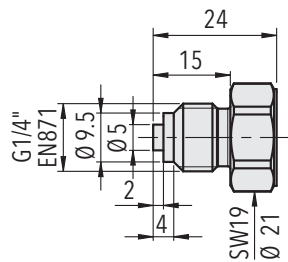

8252.XX.XX53.XX.XX.XX

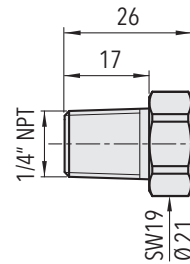

8252.XX.XX30.XX.XX.XX

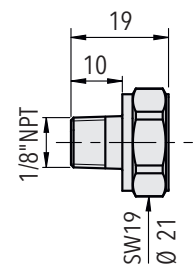

8252.XX.XX43.XX.XX.XX

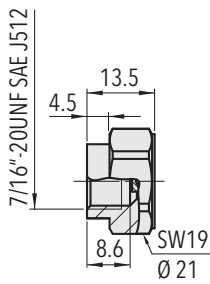

8252.XX.XX24.XX.XX.XX

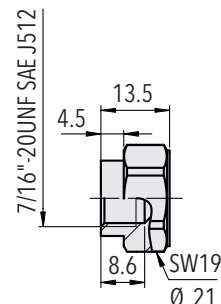

8252.XX.XX44.XX.XX.XX

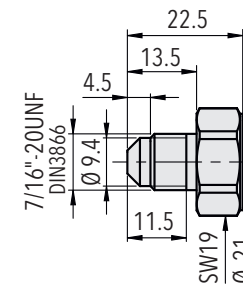

8252.XX.XX18.XX.XX.XX

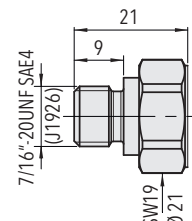

8252.XX.XX42.XX.XX.XX

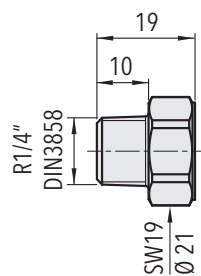

8252.XX.XX19.XX.XX.XX

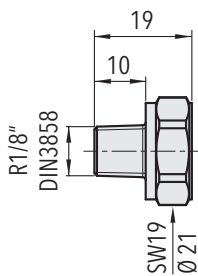

8252.XX.XX16.XX.XX.XX

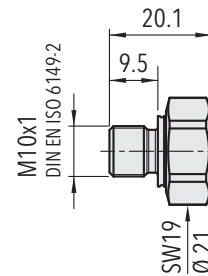

8252.XX.XX32.XX.XX.XX

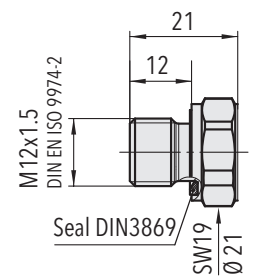

8252.XX.XX49.XX.XX.XX

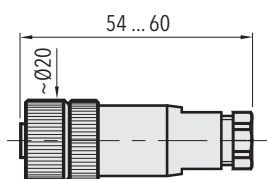

8252.XX.XXXX.XX.XX.33

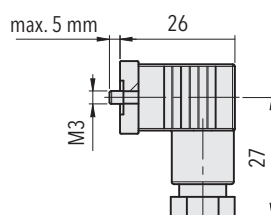

8252.XX.XXXX.XX.XX.34

Electrical connection

		Protection / electrical connection									
		IP65 *)**)		IP67 *)**)			IP67**)		IP67**)		
		Industrial standard Contact distance 9.4 mm 01		M12x1 4-pole 32			5-pole 35		Cable 22/24		Cable 08
Output signal	<p>8252.XX.XXXX.XX.19</p>	2	90	92	1	E1	4	white	red		
	<p>8252.XX.XXXX.XX.13/14/16/17/20/23/25</p>	1	91	96	E2	2	white	red			
	<p>8252.XX.XXXX.XX.PS/T1</p>	1	PS	T1	PS	T1	PS	T1	PS	T1	

*) Provided female connector is mounted according to instructions

**) Ventilation via male electric plug/cable end

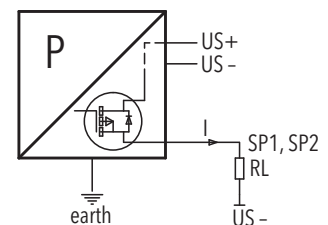
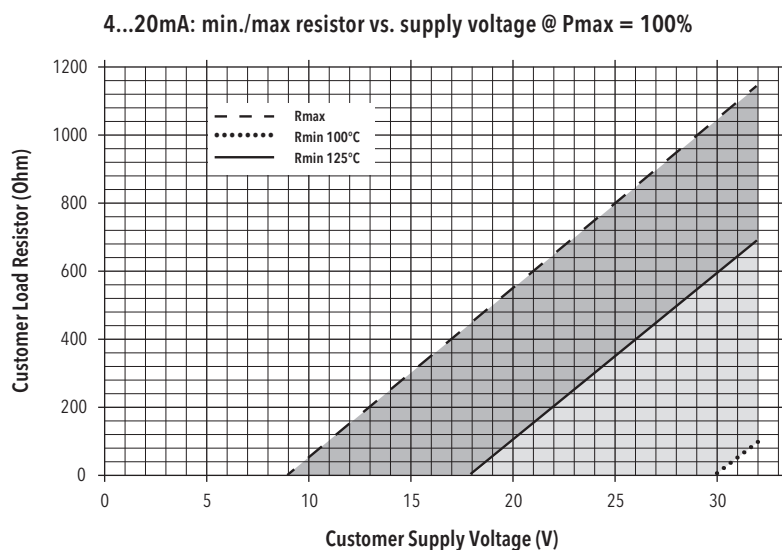

Connection of loads to switch contacts

Functions switching output

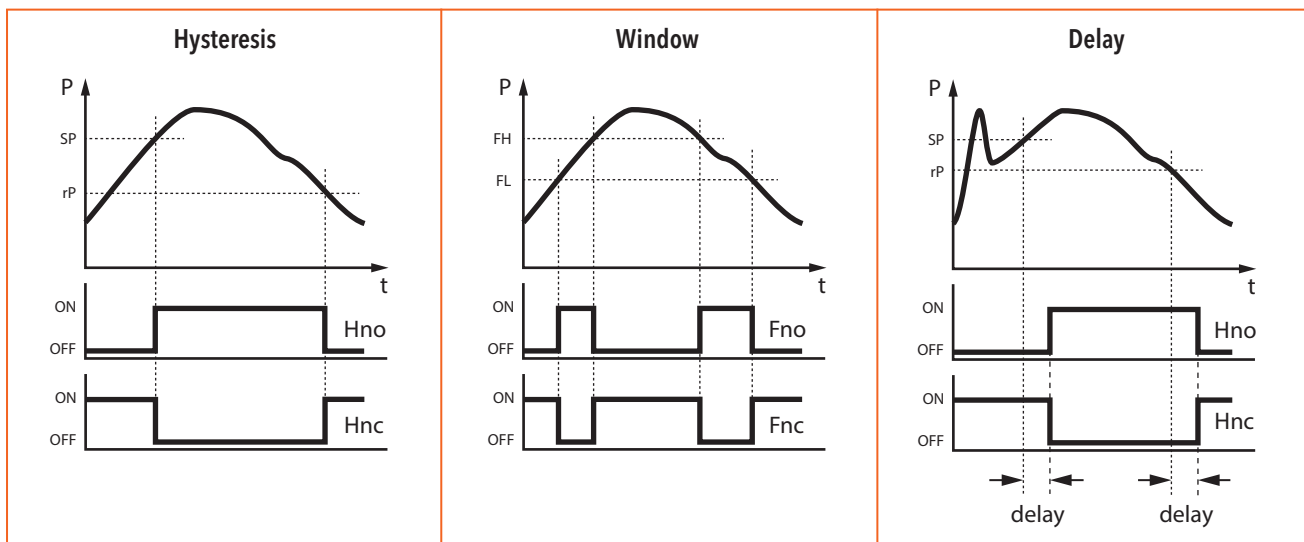

Additional information

Documents

Data sheet	www.trafag.com/H72303
Instructions	www.trafag.com/H73303
Flyer	www.trafag.com/H70666